



BoomShack

architecture re-imagined



BoomShack is a unique holistic approach to passive prefabricated construction combining a highly insulated, modular structure with sustainable design principles. The result is an attractive, contemporary, healthy and highly efficient building that requires minimal energy to maintain a comfortable internal temperature all year round.

This brochure explains some of the features of “The Bowie” display home built by **BoomShack**

boomshack.com.au

HEALTHY

Zero Volatile Organic Compounds (VOC) used in the recommended materials. Constant delivery of filtered fresh air eliminating the build up of CO² which causes drowsiness. Eliminates disease causing mould and damp.

QUICK

Adapted from the French PopUp House, BoomShack is a modular system of pre-cut lightweight elements. A kit of parts is delivered and in only 3 weeks the frame of the building can be built.

AFFORDABLE

Thanks to inexpensive materials and quick assembly, BoomShack is also a very affordable building solution. An intelligent expandable holistic floor, wall and roof system, allows you to grow your home in stages as your budget allows.

PASSIVE

Exceptional thermal performance results in a pleasant indoor temperature requiring minimal energy consumption to heat or cool the interior. Materials are consciously selected in respect to their carbon footprint and lifespan.

ENVIRONMENTAL FEATURES

- A thermal study is carried out on every structure to ensure high thermal performance outcomes
- High levels of insulation in floors, walls and roof reducing the need for energy hungry airconditioning. Temperature controlled by a Heat Recovery Ventilation system
- Buildings are installed with HRVs (Heat Recovery Ventilation systems)- a seasonally responsive management of fresh air supply and ventilation. HRVs utilise heat from outgoing stale air to warm incoming fresh air to maintain a constant comfortable temperature. We also draw the fresh air in through a "Canadian Well" or underground labyrinth that cools the incoming air on hot days.
- FSC plantation timber is used for the structure, cladding and flooring
- Construction elements are pre-cut and pre-drilled to eliminate on site waste.
- Double glazing to doors and windows
- UPVC or stable Accoya timber window frames provide an excellent thermal break to reduce heat loss/gains.
- 0% VOC paints and sealants throughout
- EPDM rubber Roof membrane offers a green roof option providing additional thermal protection.
- The type of assembly allows for a 100 percent removable and recyclable solutions
- Projects are designed and built for longevity, minimal maintenance and for future generations to enjoy





BoomShack

EXTERNAL FINISHES

- External finishes include a combination of prefinished zero maintenance "Exotec raw" fibre cement by James Hardie and Accoya vertical battening guaranteed to last for 50 years
- Double garage clad in Polycarbonate sheeting and Accoya treated timber
- Accoya secret fixed decking to verandahs, steps and decks
- Anotich Grey finish UPVC framed Low E double glazed doors and windows
- Gravel ballast flat roof design with the option of a green roof
- Pre-cast concrete paving to walkways
- Landscaping a selection of low water regime native grasses

INTERNAL FINISHES

- Rubio finished wide timber board flooring
- Modern grout free James Hardie sheeting to wet areas.
- Rock Maple ply with Rubio coating for tough internal walls and ceilings throughout.
- Internal walls constructed of highly insulated EPS walls or SIPs panels
- Kitchen Cabinets feature paper rock tops and rubio finished doors and drawers
- Top of the line Fisher and Pykel kitchen fixtures including oven, cook top rangehood, dishwasher, fridge drawer, fridge and washing machine.
- Plumbing fixtures are quality fixtures
- Full width vanity mirrors
- Semi-Frameless glass shower screens.
- Accessories- towel rails & toilet roll holders
- LED Recessed downlights and strip lights throughout.
- All double GPO power points.
- Television outlet.
- Built- in robes in rock maple ply with Rubio finish
- EPS filled doors throughout.

BoomShack

"THE BOWIE"

A THREE BEDROOM
SPATIALLY EFFICIENT
SIMPLE HEALTHY HOME

TOTAL INTERNAL AREA 112m²

KITCHEN	13m ²
DINING	17m ²
LIVING ROOM	23m ²

BED 1	18m ²
ENSUITE	6m ²
BED 2	13m ²
BED 3	15m ²
BATH	7m ²

EXTERNAL

VERANDAH	31m ²
REAR DECK	5m ²
GARAGE	38m ²
STORE 1 + 2	4m ²

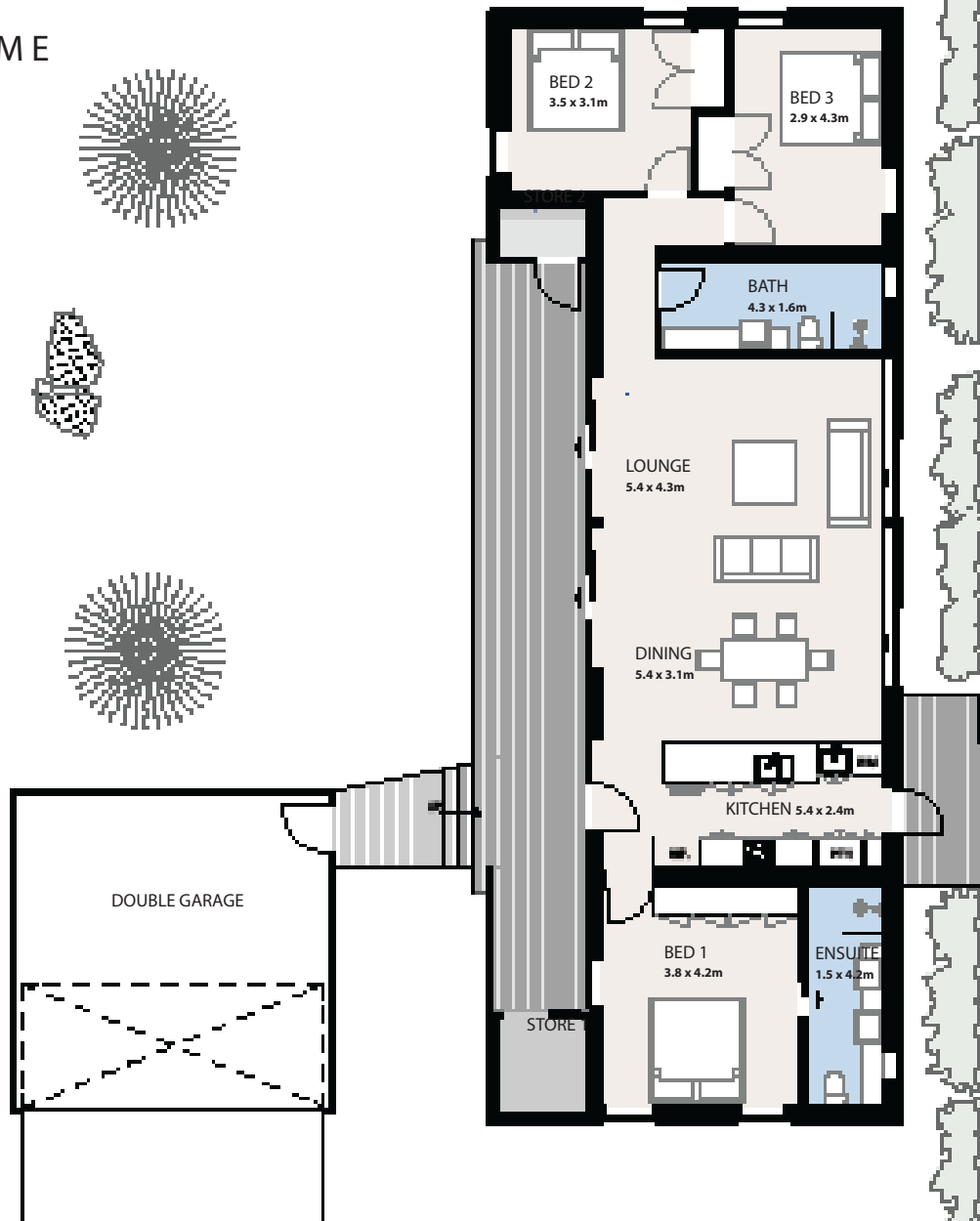



BUILD OPTIONS

OPTION ONE: Decide on a site with our free advise, use our inhouse Architects to help you design your bespoke house to suit your needs and to suit the site that will maximise your northerly aspect for good passive solar design. Our Architects will provide their services for an agreed lump sum fee. Designs can be tailored, or configured for single storey, double storey multi-residential, extensions, granny flats and commercial projects. Simplicity of construction and reduced need for trades makes it an ideal remote solution.

OPTION TWO : Customise our system with your own Architect or building designer. We provide free advise and guidance to your building designer. BoomShack have approved builders or we can provide training and consultation to your preferred builder.

BoomShack then supply the flat-pack materials constituting the structure (EPS, wood, screws) and waterproofing membrane. You then may personalize your home by selecting your preferred internal and external finishes as long as they fit within the BoomShack preferred finishes that will comply with our ethos. BoomShack then supply the flat-pack materials



BoomShack

pop·up
partner

Contact : Mark Leavesley
mobile : 0418 765 182
phone: 08 9757 311
email: mark@boomshack.com.au

Visit the PopUp website at :
www.popup-house.com

Find out more about BoomShack by visiting our website at : [boomshack .com.au](http://boomshack.com.au)